



IPL, Turbo Lite 350, 9633513-22, 2005-12

# Turbo Lite 350



**Factory:**

**Product Group:**

**Sub Group:**

**Publication Date:**

**Publication Number:**

**FLM - Newton Aycliffe**

**OM 78**

**Electric Hover: 7890**

**01/12/05**

**AP0512002**

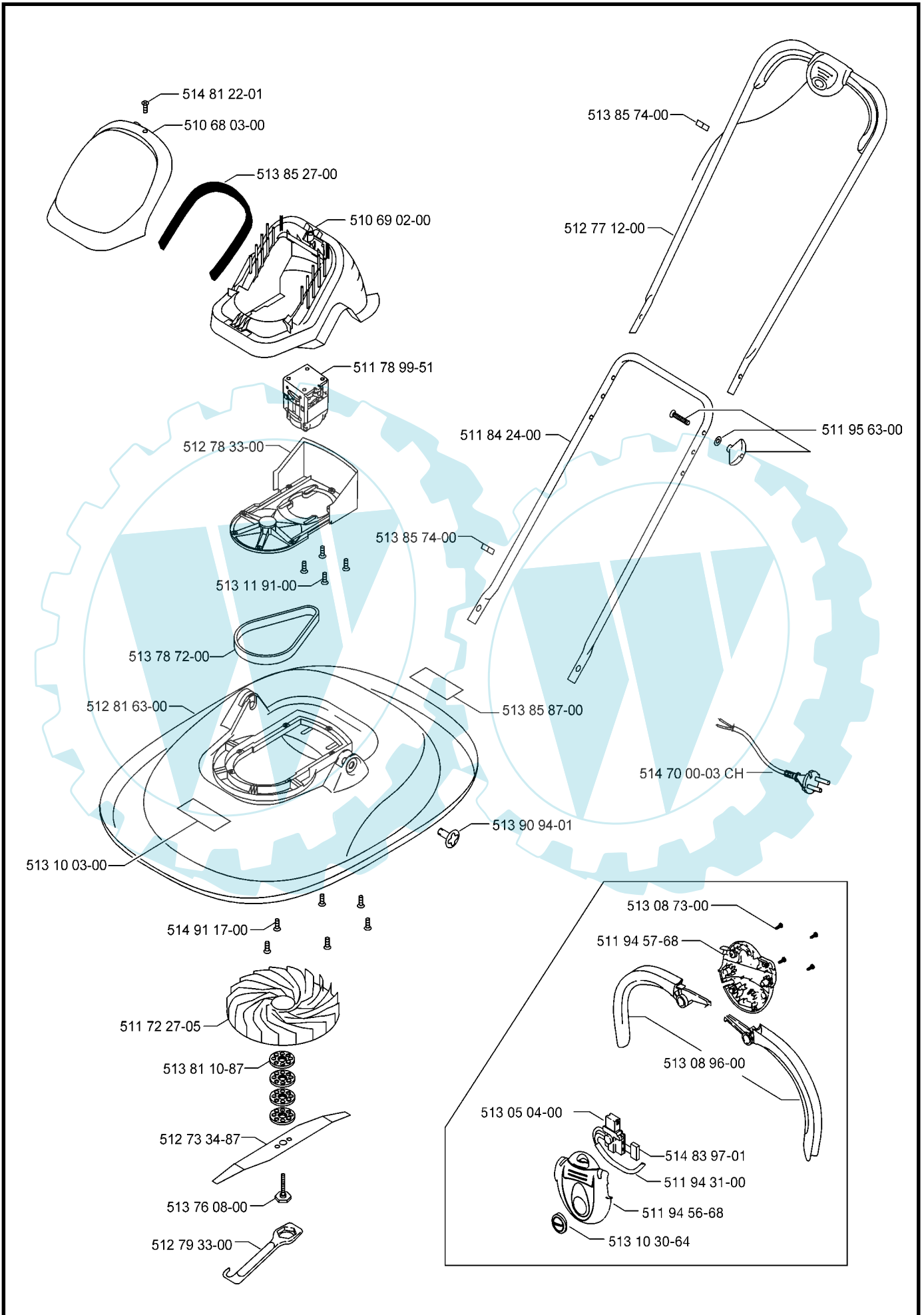

| Part Number  | Description                  | Qty | Note |
|--------------|------------------------------|-----|------|
| 510 68 03-00 | COWL UPPER                   | 1   |      |
| 510 69 02-00 | COWL LOWER                   | 1   |      |
| 511 72 27-05 | IMPELLER TC                  | 1   |      |
| 511 78 99-51 | MOTOR AMETEK 069343231.1     | 1   |      |
| 511 94 31-00 | LEAD                         | 1   |      |
| 511 94 56-68 | SWITCHBOX UPPER GREY         | 1   |      |
| 511 94 57-68 | SWITCHBOX LOWER UK INLET GRE | 1   |      |
| 511 95 63-00 | HANDLE FIXING KIT            | 1   |      |
| 512 73 34-87 | BLADE 35CM                   | 1   |      |
| 512 77 12-00 | HANDLE UPPER COATED          | 1   |      |
| 512 78 33-00 | MOTOR DRIVE ASSY TL          | 1   |      |
| 512 79 33-00 | ABS SPANNER (PLASTIC)        | 1   |      |
| 512 81 63-00 | HOOD PRINTED TL350           | 1   |      |
| 513 05 04-00 | SWITCH SPRUNG:8A 250V FK821  | 1   |      |
| 513 08 73-00 | SCREW NO6x19 POLYMATE PAN/HD | 4   |      |
| 513 08 96-00 | SWITCHBOX LEVERS KIT         | 1   |      |
| 513 10 30-64 | Button:Lock-Off Orange       | 1   |      |
| 513 11 91-00 | Screw-Cap. Washer 6 Spline   | 4   |      |
| 513 76 08-00 | BLADE BOLT ASSY (BROWN)      | 1   |      |
| 513 78 72-00 | DRIVE BELT - 406 J5          | 1   |      |
| 513 81 10-87 | BLADE SPACER                 | 4   |      |
| 513 85 27-00 | FILTER FOAM                  | 1   |      |
| 513 85 74-00 | CABLE CLIP                   | 2   |      |
| 513 85 87-00 | LABEL:WARNING (ELECTRIC)     | 1   |      |
| 513 90 94-01 | PIN PIVOT                    | 2   |      |
| 514 70 00-03 | LEAD (SWISS) (BLACK)         | 1   | CH   |
| 514 81 22-01 | SCREW PLASTITE NO.10X19MM LG | 1   |      |
| 514 83 97-01 | CAPACITOR 0.1 (FULL APPROVA  | 1   |      |
| 514 91 17-00 | SCREW                        | 7   |      |